



G3 Rear Access Series FLUORESCENT | GRID



1x TECHNISEAL® APPLICATIONS:

- UL/CUL Listed Wet Location
- Cleanroom (Classes 100-100,000; ISO Classes 5-9)
- UL/CUL Hazardous Location (Class I, Division 2; Groups A, B, C & D; Class II, Division 2; Groups F & G)
- NSF Certified Food Processing (Splash Zone, Food Zone)
- Industrial & Commercial
- Transit

BENEFITS:

- Luminaires adaptable to your specific needs
- Accessible from rear or front for servicing

FEATURES:

- Premium electronic ballast standard
- Available in stainless steel construction
- Every luminaire tested with lamps to assure customer satisfaction
- 5 year limited warranty
- Proudly made in **USA**

SPECIFICATIONS:

HOUSING:

Constructed of nominal 20GA (.036) zinc coated steel for unmatched corrosion protection. Two welded, tapered, threaded flanges on the top provide a sealed wireway access. All seams are sealed with a long life acrylic sealant.

Food Zone: All external metal components of stainless steel (S3 option std).

REFLECTOR:

Fabricated of zinc coated steel, painted with a minimum reflectance of 88%.

LENS FRAME:

Exclusively designed, heavy duty, extruded, anodized aluminum with stainless steel captive screws used to hold the lens frame tight to the housing. The frame is hinged for support while servicing.

Food Zone: All external metal components of stainless steel (S3 option std).

GASKETING:

An extruded, ribbed vinyl gasket seals the lens into the frame; with our exclusive, mechanically held, extruded, silicone gasket used to seal the frame to the housing.

Food Zone: Silicone sealant is used to seal the lens into the frame, with extruded EPDM sealing the frame to the housing.

FINISH:

Painted surfaces are two mil white polyester enamel, special colors available.

LENS:

.140 extruded prismatic acrylic with 50% DR content for durability, smooth side out.

Food Zone: .156 extruded prismatic polycarbonate, smooth side out.

ELECTRICAL:

All ballasts and lampholders are UL Listed.

MOUNTING:

Grid or custom detail available.

TEMPERATURE CODE:

Class I, Div. 2= T5 (100°C); Class II, Div. 2= T5 (100°C)

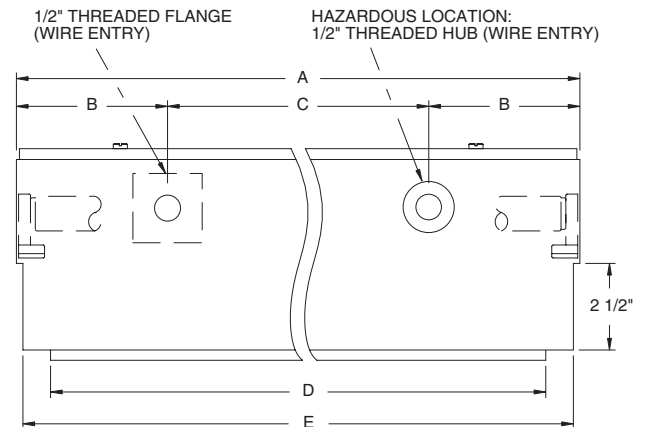
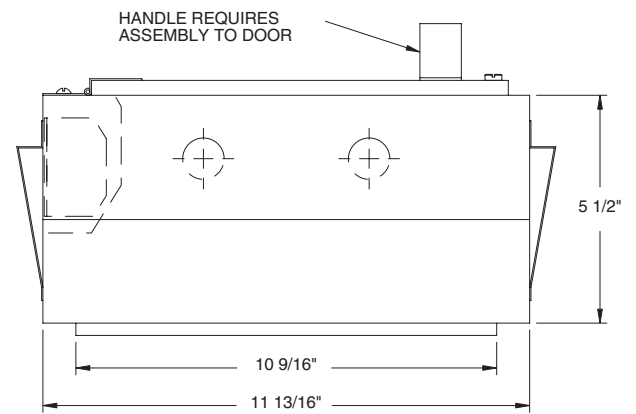

LENGTH	DIMENSIONS IN INCHES				
	A	B	C	D	E
2 FT	23 29/32	1 31/32	20	22 3/4	23 19/32
3 FT	35 29/32	1 31/32	32	34 1/2	35 19/32
4 FT	47 29/32	1 31/32	44	46 5/8	47 19/32

LENS FRAME DETAILS:

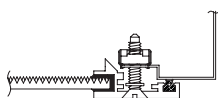

ALUMINUM
LENS FRAME DETAIL

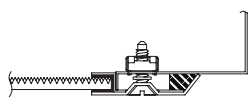

STAINLESS STEEL
LENS FRAME DETAIL

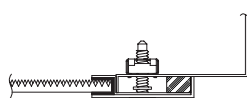

HAZ. LOC. STAINLESS STEEL
LENS FRAME DETAIL

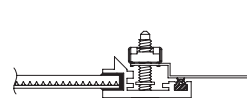

SPLASH ZONE
LENS FRAME DETAIL

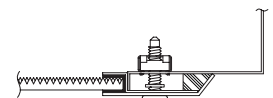

FOOD ZONE
LENS FRAME DETAIL



Hazardous Location:



Food Processing:



G3 RA Series



PHOTOMETRICS: For additional photometry, go to paramountlighting.com

Model G32324-R5, 4FT, Specular Reflector and Prismatic Acrylic Lens, 2 32W T8 Fluorescent Lamps, Lamp Lumen Rating = 3050

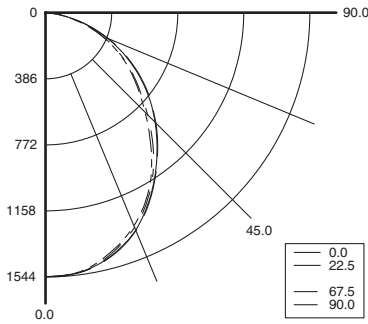

Coefficients of Utilization, Zonal Cavity Method

Floor Cavity Reflectance: 20%

RC	.8				.7				.5				.3				.1				0	
	.7	.5	.3	.1	.7	.5	.3	.1	.5	.3	.1	.5	.3	.1	.5	.3	.1	.5	.3	.1		
R 0	74	74	74	74	73	73	73	73	69	69	69	66	66	66	64	64	64	62				
C 1	68	66	63	61	67	64	62	60	62	60	58	59	58	56	57	56	54	53				
R 2	62	57	53	50	61	56	53	49	54	51	48	52	49	47	50	48	46	45				
3	57	51	46	42	56	50	45	41	48	44	41	46	43	40	45	42	39	38				
4	52	45	40	36	51	44	39	35	43	38	35	41	37	34	40	37	34	33				
5	48	40	35	31	47	40	34	31	38	34	30	37	33	30	36	32	30	28				
6	45	36	31	27	43	36	31	27	35	30	27	34	30	26	33	29	26	25				
7	41	33	28	24	40	33	27	24	32	27	24	31	27	23	30	26	23	22				
8	39	30	25	21	38	30	25	21	29	24	21	28	24	21	27	24	21	20				
9	36	28	23	19	35	27	23	19	27	22	19	26	22	19	25	22	19	18				
10	34	26	21	17	33	25	21	17	25	20	17	24	20	17	24	20	17	16				

Zonal Lumen Summary

Zone	Lumens	% Lamp	% Luminaire
0-30	1169	19.2	30.5
0-40	1867	30.6	48.7
0-60	3135	51.4	81.8
0-90	3832	62.8	100
90-120	0	0	0
90-130	0	0	0
90-150	0	0	0
90-180	0	0	0
0-180	3832	62.8	100

Total Luminaire Optical Efficiency = 62.8%

Spacing Criterion: 0° = 1.18, 90° = 1.16

1x TECHNISEAL® REAR ACCESS GRID TROFFER ORDERING INFORMATION:

SERIES	LAMP QTY	LAMP TYPE	LENS	OPT MAT	GRID	OPTIONS	VOLTAGE
G3	Wet Location	1	2 .125 Clear Acrylic (No Pattern)			EM2 Bodine BDL700 WET/IOTA I-48-DL WET or similar	120V-277V/60Hz STD
	Cleanroom	2 Standard	3 .125 White Acrylic			EM3 Bodine BDL500 WET/IOTA I-320-DL WET or similar	347V/60Hz
HG3*	Hazardous	3	4 .140 Prismatic Acrylic (P12) (base)			EM4 Bodine BDL900 WET/IOTA I-40-DL WET or similar	50Hz & Other Voltages Available
SG3	Splash Zone		6 .125 Clear Polycarbonate (No Pattern)			EM8 Bodine BHD65U HAZ. LOC.	
FG3	Food Zone		7 .125 White Polycarbonate			BALLASTS (SPECIFY VOLTAGE)	
			8 .156 Prismatic Polycarbonate (P12)			D1 Lutron Dimming ECO-10	
			9 .187 Tempered Glass (P62)			D2 Electronic Dimming	
			LENSES AVAILABLE FOR FOOD ZONE			D4 < 10% THD (Consult Factory)	
14T5	F14T5 (2FT)	0°	6 .125 Clear Polycarbonate (No Pattern)			E0 Low-Temp Electronic (N/A T12 RS & VHO)	
17*	F17T8 (2FT)	0°	7 .125 White Polycarbonate			E2 2 Electronic Ballasts	
24T5H	F24T5/HO (2FT)	0°	8 .156 Prismatic Polycarbonate (P12)(base)			E3 3 Electronic Ballasts	
31U*	FB31T8/U 1 5/8" (2FT)	0°	9 .187 Tempered Glass (P62)			E9 Rapid Start Electronic Ballast	
25	F25T8 (3FT)	0°	Colored acrylic lens available, consult agent.			FUSING	
28T5	F28T5 (4FT)	0°				F1 GLR/HLR Fusing (Fast)	
32*	F32T8 (4FT)	0°				F2 GMF/HLR Fusing (Slow)	
54T5H	F54T5/HO (4FT)	0°				LENSING	
* Lamp Type Available for Hazardous Location.							
			*S2 Stainless Steel Housing			H0 Special Lens (Specify)	
			*S3 Stainless Steel Exterior			H2 .150 Extra Heavy Clear Acrylic	
			*S5 Stainless Steel Lens Frame Only			H3 .150 Extra Heavy White Acrylic	
			* Note:			H5 .156 C73 Tempered Glass	
			If Stainless Steel is ordered,			H6 .187 Clear Tempered Glass	
			304 SS Standard			J0 Lamp Sleeves (Specify Color)	
			316 SS and other materials available, consult agent.			J2 .060 Clear Acrylic Overlay	
						J4 .020 White Acrylic Overlay (Lamp Side)	
						J6 .080 Clear Polycarbonate Overlay	
						J7 Louver (Specify)	
						J9 RFI Lens (Specify Pattern)	
						K3 .187 KSH-T2 Acri-Tuf Acrylic	
						K6 External Prisms (N/A Splash/Food Zones)	
						MISC	
						P9 Special Paint Color (Provide Paint Code & Chip)	
						R5 Specular Aluminum Reflector	
						S1 Special Material (Consult Agent)	
						T3 Tamper Resistant (Hex w/pin STD, Others Avail)	
						V1 External Gasketing	
						V3 No Silicone Sealant Used	
						W4 Inboard Outboard Wiring (Dual Switching)	
						Y5 RFI Suppressors	
						Add hyphens between options	
			G1 1 1/2" T-Bar				
			G2 2" T-Bar				
			1 Inch T-Bar Standard				

Other Wattages and Lengths Available, Consult Factory.

NSF Food Processing Note:

Food Zone (F prefix) luminaires come in DIRECT CONTACT with food. Splash Zone (S prefix) units may become soiled, but are outside the danger of recontamination.

Information subject to change without notice. Lamps supplied by others.

© 2010 Paramount Industries, Inc. P.O. Box 259 Crosswell, MI 48422

Project Information: